

Crew Boat
Abou Taha

This triple screw vessel is of all aluminum construction and is designed for high speed service in oil fields. She is licensed for 46 passengers in comfortable aircraft type seats, as well as a moderate quantity of deck cargo.



General

Year, place built	1998, Camcraft , Louisiana, U.S.A.
Flag	Egypt
Port of registry	Port Said
Dimensions	30 x 7 x 3.5 m
	Light draft 1.07 m – Laden draft 1.8 m
GRT, NRT	99 tons, 66 tons
Fuel capacity	10,600 liters
Fresh water capacity	2,600 liters
Clear deck area	14 X 5.8 m (81 m ²)
Deck tonnage	22 tons
Speed	20 knots

Navigation

Wheelhouse: fore and aft consoles, Arpa radar, echo sounder, electronic compass, auto pilot, 2 GPS, SSB, 3 VHF's.

Accommodation

Passenger capacity	46 passengers, in aircraft type seats fully air-conditioned - 2 heads, 2 showers.
Staterooms	6 berths in 2 staterooms , fully air-conditioned .

Machinery

Main engines	3 x 12V71TI Detroit Diesels
Gears	Twin Disc 514
Propellers	3 x fixed pitch propellers
Generators	2 x 3-71 Detroit Diesels 40 kw

Owners : Hamza Brothers, 8, Palestine Street, Port Said 42111, Egypt.

Tel + 2066 322 8538 , Fax + 2066 322 8830

<http://www.hamza-brothers.com>

About Taha

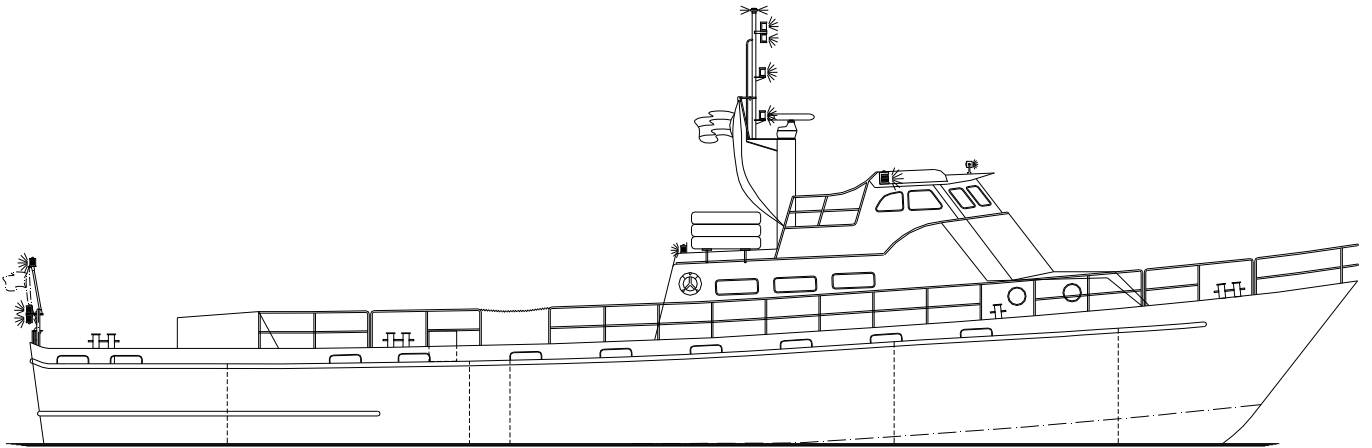

ELEVATION

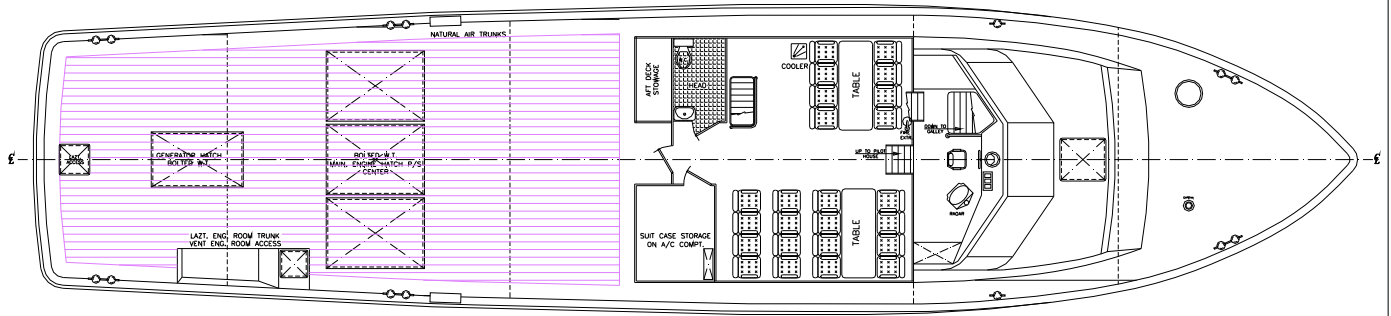

PLAN

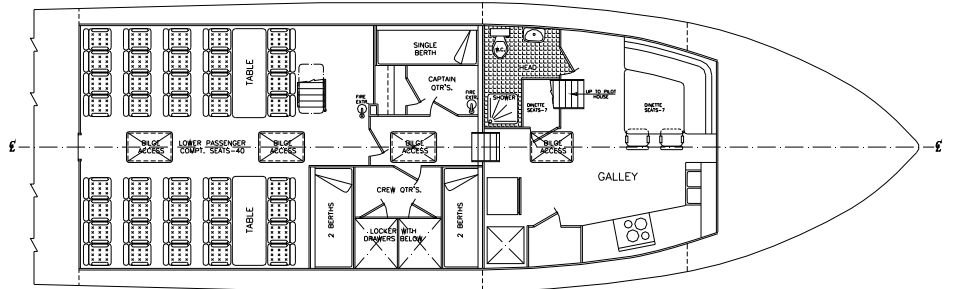

ELEVATION