

Oil Field  
Mini Supply Vessel  
**ABOU YOUSEF**



This vessel is a typical 105ft American type mini supply vessel built in Houma, Louisiana. She has a wide beam and shallow draft for her size, making it very suitable for shallow water activities. The vessel was extensively re-built, and converted to a survey boat in 1999 when accommodation was upgraded.

**General**

Year, place built	1996 Houma – Louisiana , U.S.A.
Flag	Egypt
Port of registry	Port Said
GRT	192 Tons
NRT	88 Tons
Dimensions	32.0 x 9.15 x 2.13 m
Clear deck	20.00 x 8.23 m ( 164.6m <sup>2</sup> )
Speed	10 knots .
Passengers Capacity	Licensed for 25 passengers for offshore transportation

**Cargo Capacity**

Fuel Oil	76,220 L - Transfer rate 750 L/M @ 30 m head
Fresh Water	164650 L -Transfer rate 750 L/M @ 30 m head
Deck Cargo	150 Tons

**Navigation**

Wheelhouse : Fore and aft consoles  
Radars : 1 x 48mile (Furuno) Gps feed , 1 x 36 mile not stabilized (Furuno)  
GPS : 1xFuruno gp 1650 with color plotter (primary), 1x Raytheon ,with mini plotter LCD (secondary) both have leads to connect to navigation suit on P/C.  
AIS : Furuno Universal AIS FA-100 built in gps ,connected to P/C and radar.  
Communications : 3 VHF 25w, 2 hand held VHF's , 1 SSB/HF 150w, 1 Mini M, KVH sat phone, voice ,fax and data, with fax, scanner and printer attached , JRC Navtex receiver, Auto pilot Compass, magnetic , Data marine depth sounder , Standard, horizon PA/Hailer system, general alarm connected to speakers in galley, crew quarters, back deck and engine room ,intercom system with remote handsets in galley, aft engine control position ,engine room and pilothouse.

**Accommodation**

Fully air-conditioned accommodation - Total 8 cabins - 7 x 2 berths, 1 x 4 berths .  
1 large galley , 1 large lounge , 3 heads , 3 showers .

**Propulsion**

Main Engines : 2 x 16V71 Detroit Diesels , each 750 BHP - total 1,500 BHP  
2 x fixed pitch propellers.  
Generators : 2 x 4-71 Detroit Diesels each 50 KW - 110 , 220 V, 60 HZ.

---

**Hamza Brothers, 8 Palestine Street, Port Said 42111 Egypt**

Tel+2066 322 8538-324803 - Fax +2066 322 8830

<http://hamza-brothers.com>

# Abou Yousef

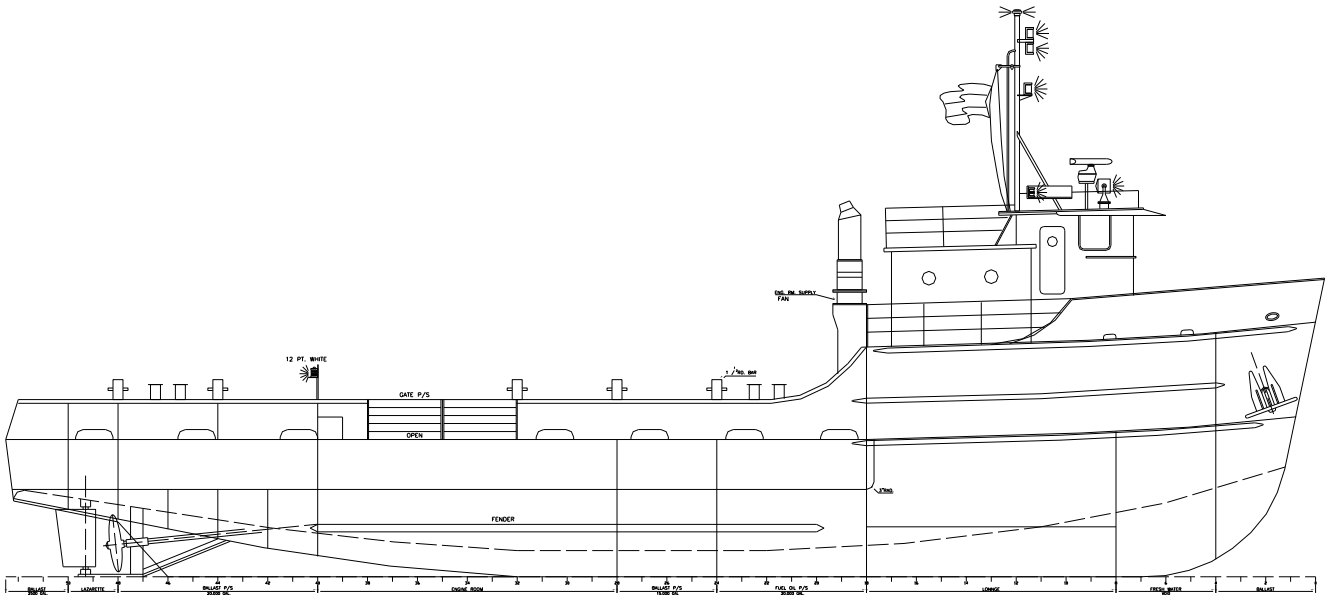

OUT BOARD PROFILE

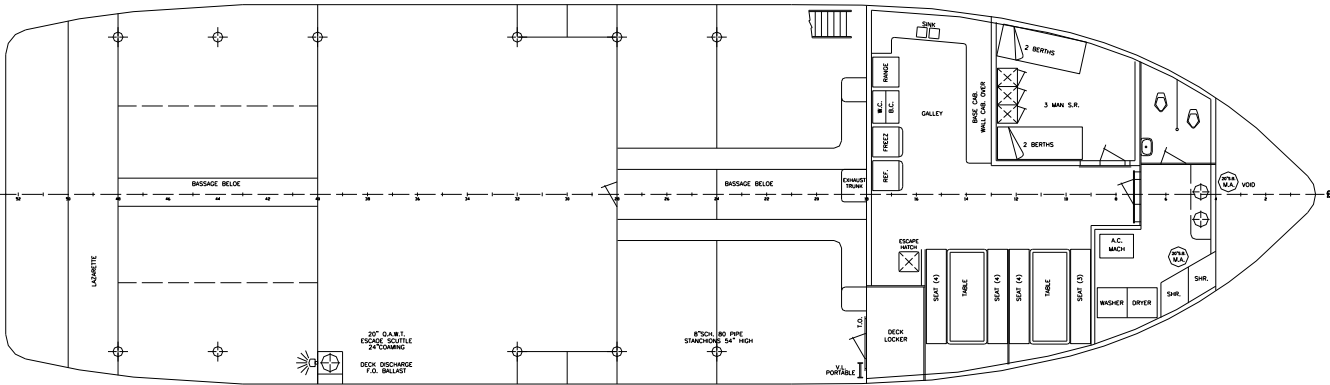

MAIN DECK

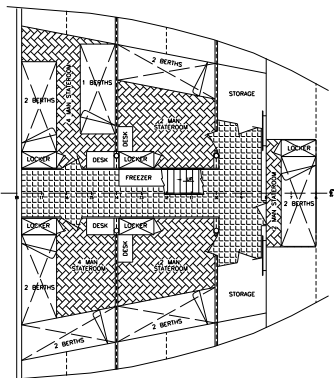

ACCOMMODATION BELOW DECK

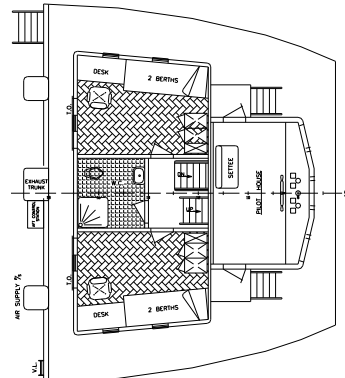

WHEEL HOUSE DECK